

# RFI FILTER

Data Sheet

Datenblatt

Fiche Technique

FILTER TYPE

NF-U-CHF100-34076

DIMENSIONS

ABMESSUNGEN

DIMENSIONS

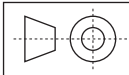
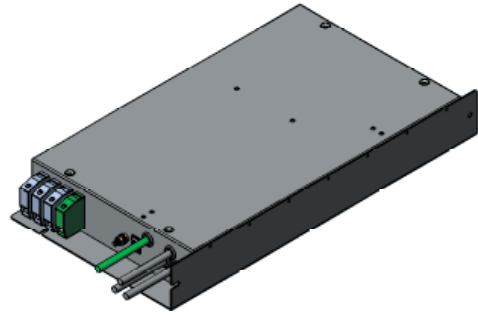
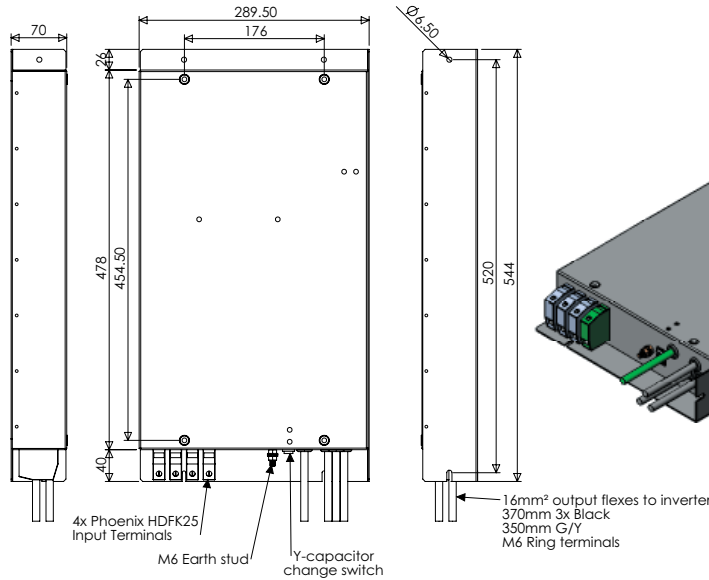

CIRCUIT DIAGRAM

ELEKTR. SCHEMA

SCHEMA ELECTRIQUE

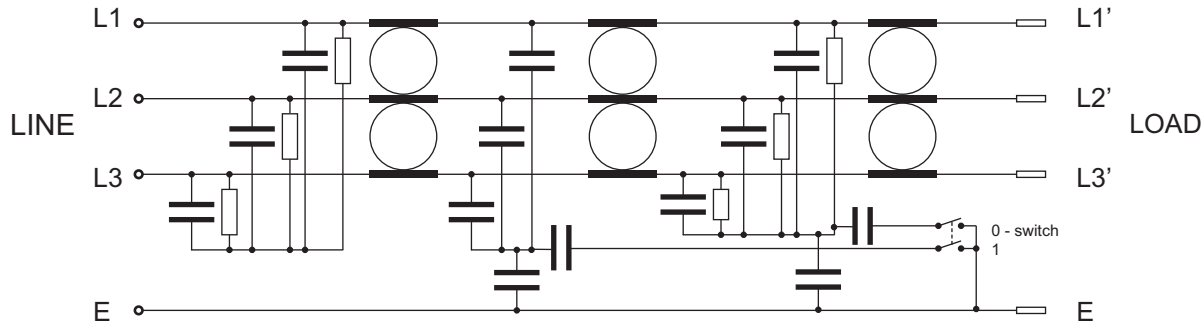

DATA	DATEN	CHARACTERISTIQUES	
RATED VOLTAGE	NENNSPANNUNG	TENSION NOMINALE	400V ±10%
RATED CURRENT	NENNSTROM	COURANT NOMINAL	76A
AT AMBIENT TEMP	BEI UMGEBUNGSTEMP	A UNE TEMPERATURE AMBIANTE	40°C
RATED OP FREQUENCY	BETRIEBSFREQUENZ	FREQUENCE DE SERVICE	48-62Hz
TEMPERATURE RANGE	ZULÄSSIGE BETRIEBSTEMP	GAMME DE TEMPERATURE	-25 -> +85°C
LEAKAGE CURRENT	ABLEITSTROM	COURANTE DE FUITE A	see right
POWER LOSS	LEISTUNGSABFALL	PERTE DE PUISSANCE	ca. 23W
FLASH TEST VOLTAGE	PRÜFSPANNUNG	TENSION D'ESSAIS	3.0kVdc (P-E)
POTTING COMPOUND	VERGUSSMASSE	MATIERE DE MOULAGE	Polyurethane
WEIGHT	GEWICHT	POIDS	ca. 7kg
APPROVALS	PRÜFZEICHEN	HOMOLOGATIONS	CE

**ADDITIONAL INFORMATION**  
**ZUSATZANGABEN**  
**INFORMATIONS SUPPLEMENTAIRES**

filter is intended for use with invt CHF100-030G/037P-4  
 400V three-phase inverters

Switch sets leakage current  
 0: 0.03mA nom / 4mA max  
 1: 0.05mA nom / 8mA max

built according to EN 60939-1, UL 1283, RoHS (2002/95/EC)

**Design and Test Criteria**

Generally with motor drive systems, the emission levels are greatly affected by the length of the cable between the drive itself and the motor - longer cables will cause considerably higher emissions.

The inverter filter combinations here have been designed and tested to achieve compliance to:

- EN 55022:2006 Class B for use in domestic / light industrial environments (Equivalent to the RF emissions tests of Power Drive Standard EN 61800-3:2004 cat. C1) when fitted with up to 25m motor output cable (switch in position 1) resp. up to 10m motor output cable (switch in position 0)
- EN 55011:2006 Class A (Group 1) for use in industrial environments (Equivalent to the RF emissions tests of Power Drive Standard EN 61800-3:2004 cat. C2) when fitted with up to 50m motor output cable (switch in position 1) resp. up to 25m motor output cable (switch in position 0)

9				
8				
7				
6				
5				
4				
3				
2	0.3 additional infos	02.07.09	TB	DRAWN BY CDJ APPROVED BY TB DATE: 08.04.2009
1	0.2 cable lengths revised	16.06.09	TB	
MODIFICATIONS		DATE	AUTHORISED	

<b>FILTER TYPE</b>	<b>NF-U-CHF100-34076</b>
<b>DRAWING No.</b>	<b>DS 304-CHF</b>
<b>ISSUE No.</b>	<b>0.4</b>

