

## Data sheet

### Modul surface mount housing 12 port pure white, unequipped

Page 1/5

P/N  
130861-1202-E

EAN 4250184114420

2017-16-08

## Illustrations



Dimensional drawing

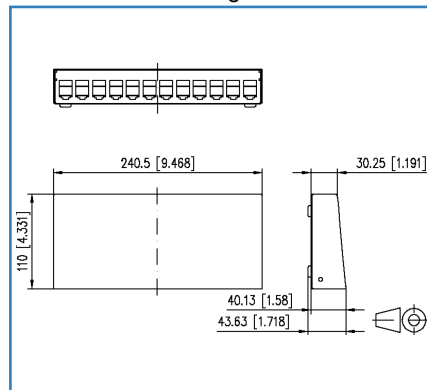

Cut-out

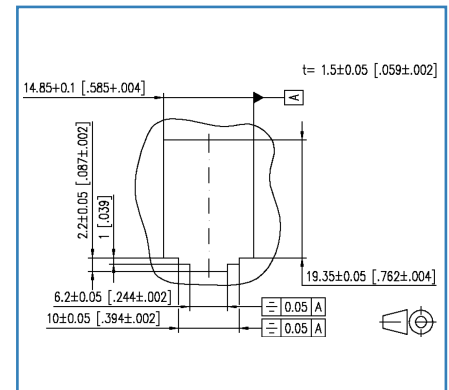

See enlarged drawings at the end of document

## Product specification

- surface-mounted, unequipped module housing for individual modules in modul design
  - solid steel sheet housing
  - upper part of the housing powder-coated in RAL 9010
  - upper part of the housing can be put on and removed easily because no screws are used for fastening
  - equipotential bonding possible by means of contact pin
  - additional strain relief on lower part of housing using cable ties
  - suitable for direct wall mounting, as desktop device and for DIN-rail mounting using the DIN rail adapter mini FS
  - bottom of the 3-port and 4-port housing can be removed. Additional fastening by means of 60 mm fastening clearance.
  - optionally available and fits in all housings: FO extension set for module and keystone surface mount housing: 130861-MSK-E
  - optionally available 2 x 12 housing: Strain relief for patch cords 130861-24ZE-E
- variants: 3, 4, 6, 8, 12, 16 and 2 x 12 ports



## Modul surface mount housing 12 port pure white, unequipped

P/N

130861-1202-E

EAN 4250184114420

2017-16-08

### Technical Data

#### General Data

Fields of application	Office
Design	patch panel
Color	pure white
Dimensions	
Dimension (L x W x H)	110.00 x 240.50 x 43.63 mm
Dimension (L x W x H)	4.331 x 9.469 x 1.718 in.
Modularity	yes

#### Connections/interfaces

Number of ports interface 1	12
Number of equipped ports interface 1	0
Number of ports interface 2	12
Number of ports interface 2 equipped	0

#### Mechanical characteristics

Cut-out	Modul
strain relief	cable tie

#### Materials and material properties

Material - Housing	aluminium-zinc sheet
Material - Front cover	aluminium-zinc sheet
Material - Cover	steel

#### Environmental conditions

Temperature (min. - max.)	
Temperature - Storage °C	-40 - 70 °C
Temperature - Storage °F	-40 - 158 °F
Temperature - Operating °C	-40 - 70 °C
Temperature - Operating °F	-40 - 158 °F



Data sheet

Page 3/5

**Modul surface mount housing 12 port pure white, unequipped**

P/N

130861-1202-E

EAN 4250184114420

2017-16-08

**Technical Data****Approvals**

RoHS	compliant
------	-----------

**Classifications**

ETIM 5.0	EC001128
ETIM 6.0	EC001128

**Packing details**

Type of packaging	1 pc(s) / box
Packaging unit - Weight (gram)	588.00 g
Packaging unit - Weight (pound)	1.30 lb
Packaging dimension (W x H x D)	263.00 x 135.00 x 50.00 mm
Packaging dimension (W x H x D)	10.354 x 5.315 x 1.969 in.



## Modul surface mount housing 12 port pure white, unequipped

P/N

130861-1202-E

EAN 4250184114420

2017-16-08

### Accessories

P/N	Designation
130910-I	E-DAT modul Cat.6 <sub>A</sub> 8(8) jack, T568A
1309A0-I	E-DAT modul Coupler 8(8) 180° Cat.6
15091071-I	OpDAT modul LC-D (ceramic, blue) SM
15091001-I	OpDAT modul ST (ceramic, light gray) SM
130910-I-B1	E-DAT modul Cat.6 <sub>A</sub> 8(8) jack, T568B
130B11-E	C6 <sub>A</sub> modul 180° jack
15091072-I	OpDAT modul LC-D (ceramic, aqua) MM
130861-MSK-E	FO extension set for module and keystone surface mount housing
15091076-I	OpDAT modul LC-D APC (ceramic, green) SM
15091075-I	OpDAT modul LC-D (ceramic, heather violet) MM
1509107B-I	OpDAT modul LC-D (ceramic, beige) MM
130910-Z	E-DAT modul Cat.6 <sub>A</sub> 8(8) jack, T568A (12 pcs)



**Modul surface mount housing 12 port pure white, unequipped**

P/N  
130861-1202-E  
EAN 4250184114420

2017-16-08

**Illustrations**

Dimensional drawing

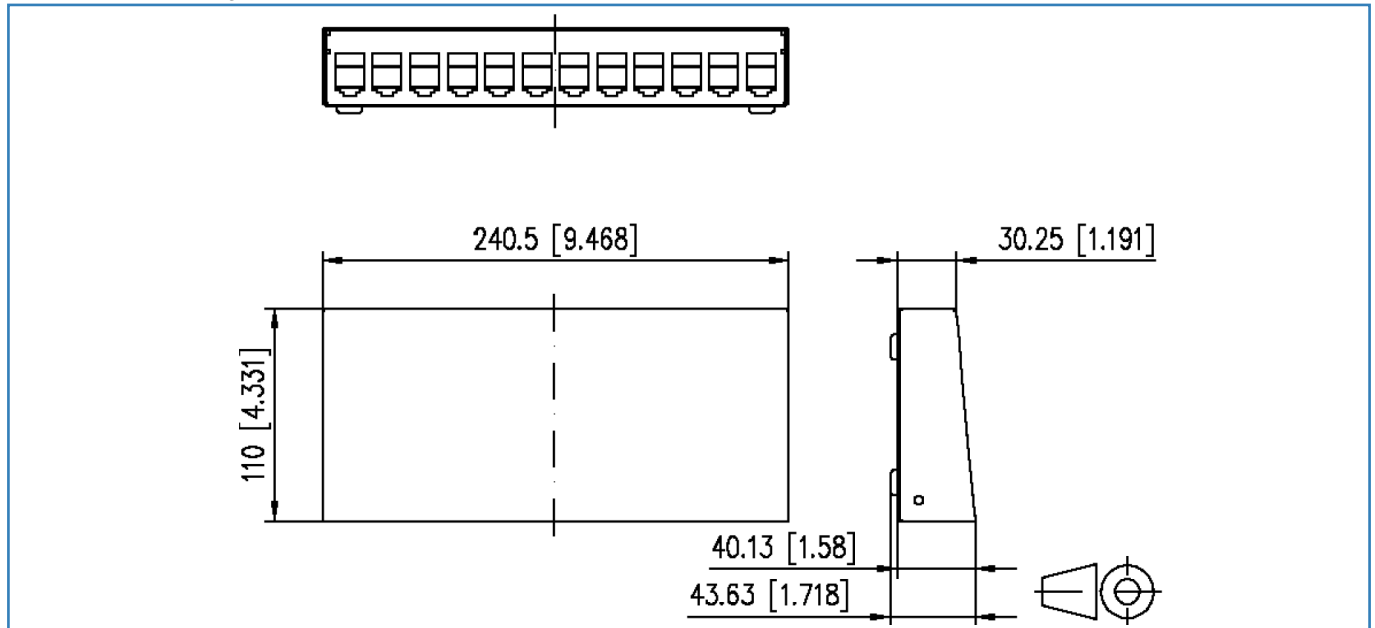

Cut-out

